

PROJECT
 PLAN PROPOSED U/S-394 OF K.M.C. ACT. 1980 FOR
 COMMERCIAL BUILDING COMPLEX (BLOCK - A, B+G+16
 STORED OFFICE BUILDING, BLOCK - B, G+12 STORED
 RESIDENTIAL BUILDING FOR HOSTEL ACCOMMODATION
 & BLOCK-C, G+4 STORED RESIDENTIAL BUILDING, AND
 EXISTING BLOCK-1 TWO STORED HOSTEL, EXISTING
 BLOCK-2 TWO STORED LIBRARY & EXISTING BLOCK-3
 FOUR STORED RESIDENTIAL BUILDING)
 AT PREMISES NO. - 224, ACH JAGADISH BOSE ROAD
 (A.J.C. BOSE ROAD), KOLKATA - 700017, WARD NO. - 69;
 BOROUGH - VIII; P. S. - KARAYA, P.O. - CIRCUS AVENUE
 LEGALITY OF EXISTING STRUCTURES ARE MORE OR
 LESS AS PER BS. NO. 108 (D-IV) DATED 09.12.1983.

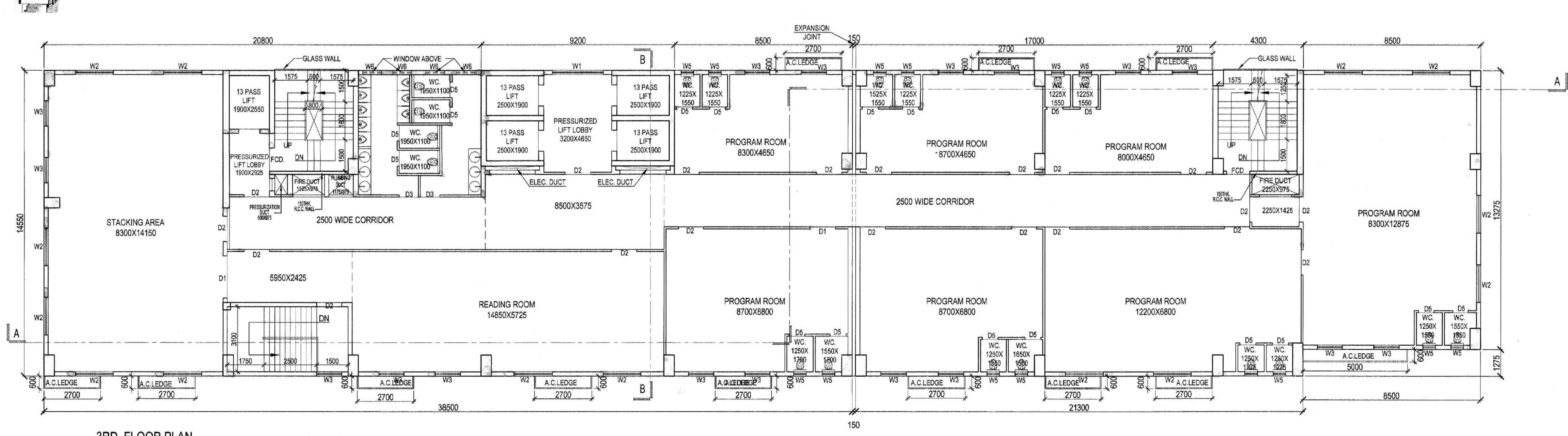
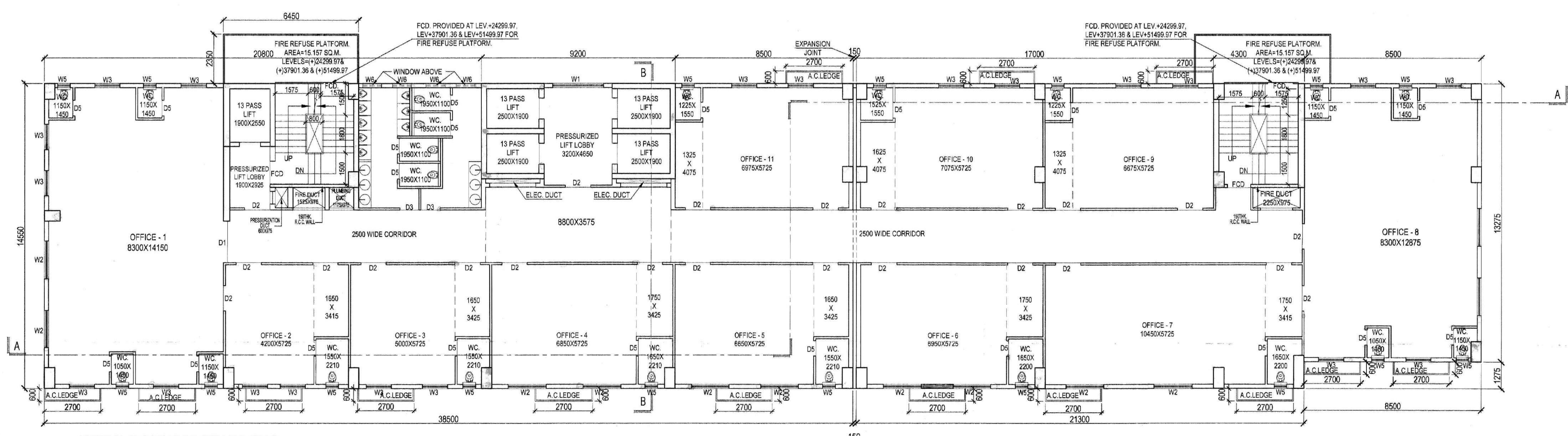
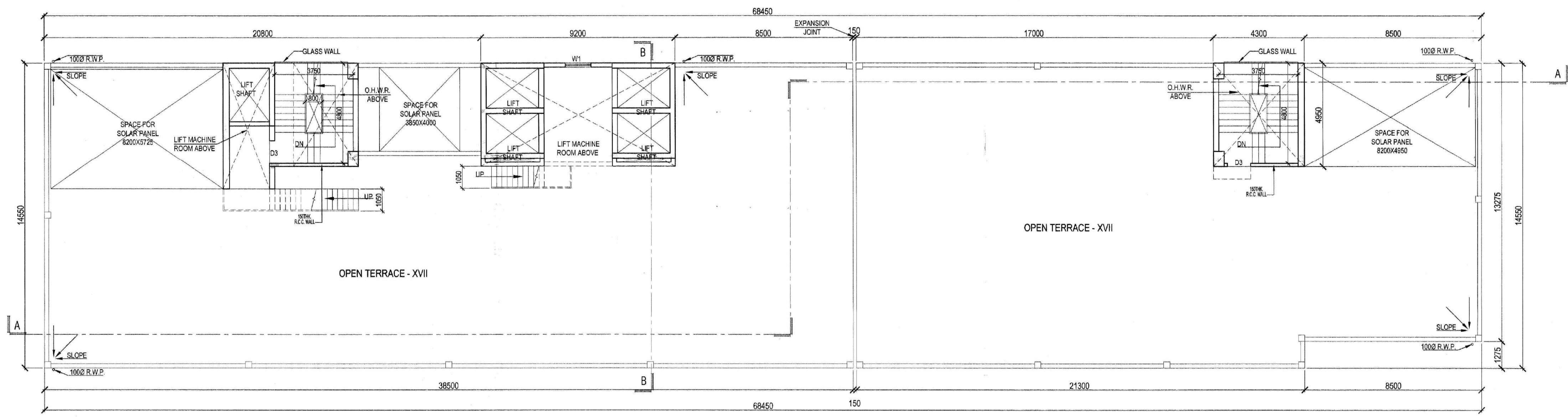
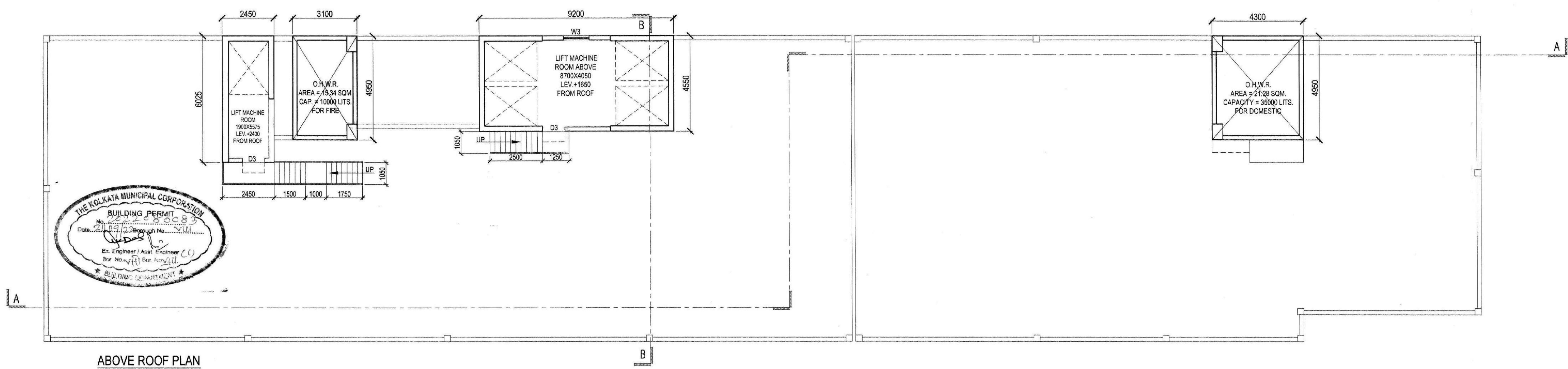

SCHEDULE OF DOORS & WINDOWS

DOORS			WINDOWS		
TYPE	WIDTH	HEIGHT	TYPE	WIDTH	HEIGHT
FCD	1200	2150	W1	2400	1800
D1	2000	2150	W2	1800	1800
D2	1200	2150	W3	1250	1800
D3	1000	2150	W4	900	900
D4	500	2150	W4a	900	1600
D5	750	2150	W5	600	900
SLD.1	2400	2150	W5a	750	400
SLD.2	2000	2150			
SLD.3	1800	2150			

- SPECIFICATION:**
1. ALL DIMENSIONS ARE IN MM UNLESS IT IS MENTIONED
 2. ALL EXTERNAL BRICK WALLS ARE 200 MM THICK AND INTERNAL 100 MM THICK UNLESS IT IS MENTIONED OTHERWISE
 3. ALL BRICKWORK PLASTERING INSIDE OR OUTSIDE ARE IN THE RATIO OF 1:5 & 1:4 RESPECTIVELY AND OUTSIDE PLASTERING CONTAINS WATER PROOFING
 4. ALL CIVIL WORKS ARE AS PER IS 456 AND ALL REINFORCEMENT AS PER IS 1176
 5. ALL R.C.C. WORKS ARE IN THE RATIO - 1 : 1.5 : 3.
 6. ALL PRECAUTIONARY MEASURES SHALL BE TAKEN AT THE TIME OF CONSTRUCTION OF UNDERGROUND WATER RESERVOIR & S.T.P.
 7. DEPTH OF WATER RESERVOIR SHALL NOT BE MORE THAN THE DEPTH OF MAIN COLUMN FOUNDATION.
 8. U.G.W.R & S.T.P. WILL BE CONSTRUCTED IN A PHASE WISE MANNER AND ALL SORTS OF PRECAUTIONARY MEASURES WILL BE TAKEN DURING CONSTRUCTION OF THE SAME.

I DO HEREBY DECLARE WITH FULL RESPONSIBILITY THAT I SHALL ENGAGE ARCHITECT & E.E.E DURING CONSTRUCTION. I SHALL FOLLOW THE INSTRUCTION OF ARCHITECT & E.E.E DURING CONSTRUCTION OF THE BUILDING. I SHALL BE RESPONSIBLE FOR THE STRUCTURAL STABILITY OF THE BUILDING & ALL WORKS. I SHALL NOT BE RESPONSIBLE FOR THE CONSTRUCTION OF U.G.W.R & S.T.P. TAKEN UNDER THE GUIDANCE OF ARCHITECT & E.E.E BEFORE STARTING BUILDING FOUNDATION.

For INDIAN CHURCH TRUSTEES
 Signature of Owner
 SIGNATURE OF OWNER

TITLE : BLOCK - A
 3RD. FLOOR PLAN,
 4TH. TO 16TH. FLOOR PLAN,
 ROOF PLAN & ABOVE ROOF PLAN
BLOCK - A
 3

SHEET NO. - ESP/224J/C/ARCH-03

CERTIFIED THAT THE PLAN ITSELF WITH FULL RESPONSIBILITY THAT THE BUILDING PLAN HAS DRAWN UP AS PER PROVISION OF K.M.C. BUILDING RULES 2008, AS AMENDED FROM TIME TO TIME AND THE SITE CONDITION INCLUDING THE ADJUTING ROAD IS CONFORM WITH THE PLAN. IT IS A BUILDABLE SITE NOT A TANK OR FILLED UP TANK. THERE IS AN EXISTING STRUCTURE. TO BE DEMOLISHED BEFORE COMMENCEMENT OF WORK IF IT IS FULLY OCCUPIED BY THE OWNER. THERE IS NO TANK.

DEBATOSH SAHU
 Architect + Urban Designer
 (ARCH. REG. NO. 11544-4)
 (E.E.E. REG. NO. 104 (II) K. M. C.)
 SIGNATURE OF ARCHITECT

SANJIV PAREKH
 M. Sc. (Struct. Engrg.), M. E. (Const. Engrg.)
 R.C.E. (REG. NO. 104 (II) K. M. C.)
 SIGNATURE OF STRUCTURAL ENGINEERS

SANJIV GUHA
 B.Sc. (Civil), M.E. (Const. Engrg.)
 Chartered Engineer
 Registered Structural Engineer with K.M.C.
 (E.E.E. REG. NO. 104 (II) K. M. C.)
 SIGNATURE OF STRUCTURAL REVIEWER

UNACKNOWLEDGED HAS INSPECTED THE SITE AND CARRIED OUT SOIL INVESTIGATION THEREON. IT IS CERTIFIED THAT THE EXISTING SOIL OF THE SITE IS ABLE TO CARRY THE LOAD COMING FROM PROPOSED CONSTRUCTION AND THE FOUNDATION SYSTEM PROPOSED THEREIN IS SAFE AND STABLE IN ALL RESPECTS.

JISHNU PAL
 B.Tech (Civil), M.E. (Const. Engrg.)
 K.M.C. Reg. No. G.7/1/32
 OTHER REGISTRATION NO. 104 (II) K. M. C.
 22/RJ/S/O/G-T/1/2016-17
 HMC Reg. No. 1077/C/ASR-1/15
 JISHNU PAL G.T.E.-112
 SIG. OF GEO-TECHNICAL ENGINEER

DESIGNED: DRG. NO.
 CHECKED: SCALE = 1:100
 DEALT: LOVELY
 DATE =

architect:
ESPACE
 35-A, DR. SARAT BANERJEE ROAD, KOLKATA-700029
 Tel/Fax: 91-33-2465-4130 / 4159
 e-mail: info@spacesindia.com
 WEBSITE: www.spacesindia.com

THIS DRAWING IS A PROPERTY OF ESPACE AND BY NO MEANS SHALL THIS BE COPIED, LENT OUT IN WHOLE OR PART, WITHOUT PRIOR PERMISSION FROM THE CONSULTANTS.